

Použití - Usage - Applikation - Употребление

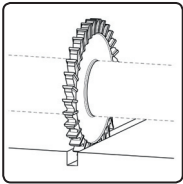

- 1 2 4 5 7 8 11 12

HSS
Co5

D js 16	S k 11	d H 7	Z	CODE 739275	IDENT.
50	4	16	16	•	.05004
50	5	16	16	•	.05005
50	6	16	16	•	.05006
50	8	16	16	•	.05008
50	10	16	16	•	.05010
63	4	22	18	•	.06304
63	5	22	18	•	.06305
63	6	22	18	•	.06306
63	8	22	18	•	.06308
63	10	22	18	•	.06310
63	12	22	18	•	.06312
63	14	22	18	•	.06314
63	16	22	18	•	.06316
63	18	22	18	•	.06318
80	5	27	20	•	.08005
80	6	27	20	•	.08006
80	8	27	20	•	.08008
80	10	27	20	•	.08010
80	12	27	20	•	.08012
80	14	27	20	•	.08014
80	16	27	20	•	.08016
80	18	27	20	•	.08018
80	20	27	20	•	.08020
100	6	32	24	•	.10006
100	8	32	24	•	.10008
100	10	32	24	•	.10010
100	12	32	24	•	.10012



▼
 Pokračování - Continuation - Fortsetzung - Продолжению

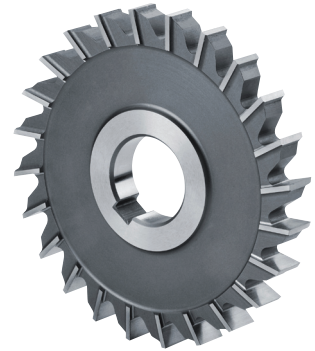
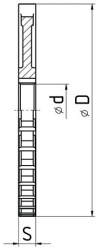

Použití - Usage - Applikation - Употребление

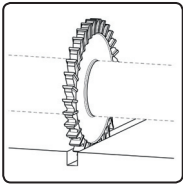

▼
 Pokračování - Continuation - Fortsetzung - Продолжению

HSS
 Co5

D js 16	S k 11	d H 7	Z	CODE 739275	IDENT.
100	14	32	24	•	.10014
100	16	32	24	•	.10016
100	18	32	24	•	.10018
100	20	32	24	•	.10020
100	22	32	24	•	.10022
100	25	32	24	•	.10025
125	8	32	24	•	.12508
125	10	32	24	•	.12510
125	12	32	24	•	.12512
125	14	32	24	•	.12514
125	16	32	24	•	.12516
125	18	32	24	•	.12518
125	20	32	24	•	.12520
125	25	32	24	•	.12525
160	10	40	24	•	.16010
160	12	40	24	•	.16012
160	14	40	24	•	.16014
160	16	40	24	•	.16016
160	18	40	24	•	.16018
160	20	40	24	•	.16020
200	10	40	32	•	.20010
200	12	40	32	•	.20012
200	14	40	32	•	.20014
200	16	40	32	•	.20016
200	18	40	32	•	.20018
200	20	40	32	•	.20020



Příklad objednávky - Example of order - Bestellsbeispiel - Пример заказа

739275.05004 + TiN