

HSS

p ±20'	D js 16	S js 14	d H 7	Z	CODE 853270	IDENT.
45°	40	10	10	14	•	.045040
45°	50	13	13	16	•	.045050
45°	63	18	16	18	•	.045063
45°	80	22	22	20	•	.045080
45°	100	28	27	22	•	.045100
45°	125	36	32	24	•	.045125
45°	160	45	40	28	•	.045160
50°	40	13	10	14	•	.050040
50°	50	16	13	16	•	.050050
50°	63	20	16	18	•	.050063
50°	80	25	22	20	•	.050080
50°	100	32	27	22	•	.050100
50°	125	40	32	24	•	.050125
50°	160	50	40	28	•	.050160
55°	40	13	10	14	•	.055040
55°	50	16	13	16	•	.055050
55°	63	20	16	18	•	.055063
55°	80	25	22	20	•	.055080
55°	100	32	27	22	•	.055100
55°	125	40	32	24	•	.055125
60°	40	13	10	14	•	.060040
60°	50	16	13	16	•	.060050
60°	63	20	16	18	•	.060063
60°	80	25	22	20	•	.060080
60°	100	32	27	22	•	.060100
60°	125	40	32	26	•	.060125
60°	160	50	40	28	•	.060160

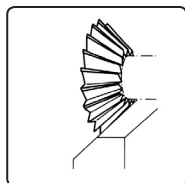

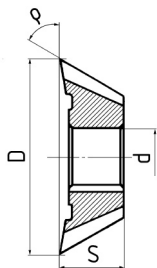

HSS

p ±30'	D js 16	S js 16	d H 7	Z	CODE 853570	IDENT.
40°	63	10	22	18	•	.040063
40°	100	20	32	22	•	.040100
45°	63	12	22	18	•	.045063
45°	80	16	27	20	•	.045080
45°	100	22	32	22	•	.045100
50°	50	12	16	16	•	.050050
50°	63	16	22	18	•	.050063
50°	80	20	27	20	•	.050080
50°	100	25	32	22	•	.050100
60°	50	12	16	14	•	.060050
60°	63	16	22	16	•	.060063
60°	80	20	27	18	•	.060080
60°	100	25	32	20	•	.060100
65°	63	16	22	16	•	.065063
65°	80	20	27	18	•	.065080
70°	50	12	16	14	•	.070050
70°	63	16	22	16	•	.070063
70°	80	20	27	18	•	.070080
70°	100	25	32	20	•	.070100
75°	63	16	22	16	•	.075063
75°	80	20	27	18	•	.075080
80°	50	12	16	14	•	.080050
80°	63	16	22	16	•	.080063
80°	80	20	27	18	•	.080080
80°	100	25	32	20	•	.080100
85°	63	16	22	16	•	.085063
85°	80	20	27	18	•	.085080



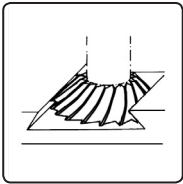
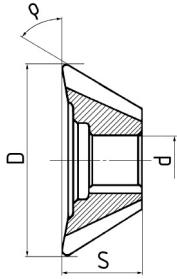

HSS

ρ -10'	D js 16	S js 16	d H 7	Z	CODE 853970	IDENT.
55°	63	20	22	16	•	.055063
55°	80	25	27	18	•	.055080
55°	100	32	32	20	•	.055100
55°	125	40	40	22	•	.055125

