

HSS

ρ $\pm 30'$	R	D js 16	S js 16	d H 7	Z	CODE 856170	IDENT.
30°	1	63	8	16	14	•	.030063
30°	1	80	12	22	16	•	.030080
30°	1,5	100	16	27	18	•	.030100
30°	2	125	20	27	20	•	.030125
30°	2,5	160	25	32	22	•	.030160

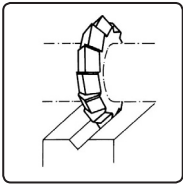

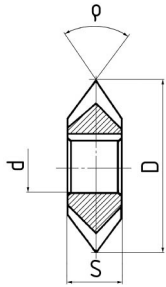

HSS

ρ ±30'	D js 16	S js 16	d H 7	Z	CODE 857070	IDENT.
45°	50	8	16	22	•	.045050
45°	63	10	22	24	•	.045063
45°	80	12	27	26	•	.045080
45°	100	18	32	28	•	.045100
60°	50	10	16	18	•	.060050
60°	63	14	22	20	•	.060063
60°	80	18	27	22	•	.060080
60°	100	25	32	24	•	.060100
90°	50	14	16	16	•	.090050
90°	63	20	22	18	•	.090063
90°	80	22	27	20	•	.090080
90°	100	32	32	24	•	.090100
*120°	50	14	16	16	•	.120050
*120°	63	20	22	16	•	.120063
*120°	80	25	27	20	•	.120080
*120°	100	36	32	24	•	.120100



* / ≠ DIN 847

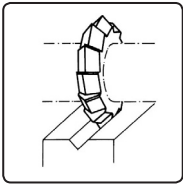
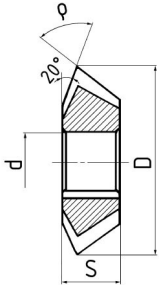

HSS

p ±30'	D js 16	S js 16	d H 7	Z	CODE 859170	IDENT.
45°	63	8	22	18	•	.045063
45°	100	16	32	22	•	.045100
50°	63	10	22	18	•	.050063
50°	80	14	27	20	•	.050080
50°	100	18	32	22	•	.050100
55°	63	10	22	18	•	.055063
55°	100	20	32	22	•	.055100
60°	63	12	22	18	•	.060063
60°	80	18	27	20	•	.060080
60°	100	24	32	22	•	.060100
65°	63	12	22	18	•	.065063
65°	100	26	32	22	•	.065100
70°	63	16	22	18	•	.070063
70°	80	22	27	20	•	.070080
70°	100	32	32	22	•	.070100
75°	63	16	22	18	•	.075063
75°	100	32	32	22	•	.075100
80°	63	16	22	18	•	.080063
80°	80	22	27	20	•	.080080
80°	100	32	32	22	•	.080100
85°	63	22	22	18	•	.085063
85°	100	36	32	22	•	.085100
90°	63	22	22	18	•	.090063
90°	80	28	27	20	•	.090080
90°	100	36	32	22	•	.090100

